

**AMERICAN SCHOOL OF
GAS MEASUREMENT
TECHNOLOGY**
SEPTEMBER 16-19, 2019
HOUSTON MARRIOTT WESTCHASE
EXHIBIT HALL AND PREFUNCTION
HOUSTON, TEXAS

EXHIBIT HALL as of 09/06/2019

Dimension	Size	Qty	SqFt
7'-6"x10'	75	48	3,600
8'x10'	80	92	7,360
Totals:		140	10,960

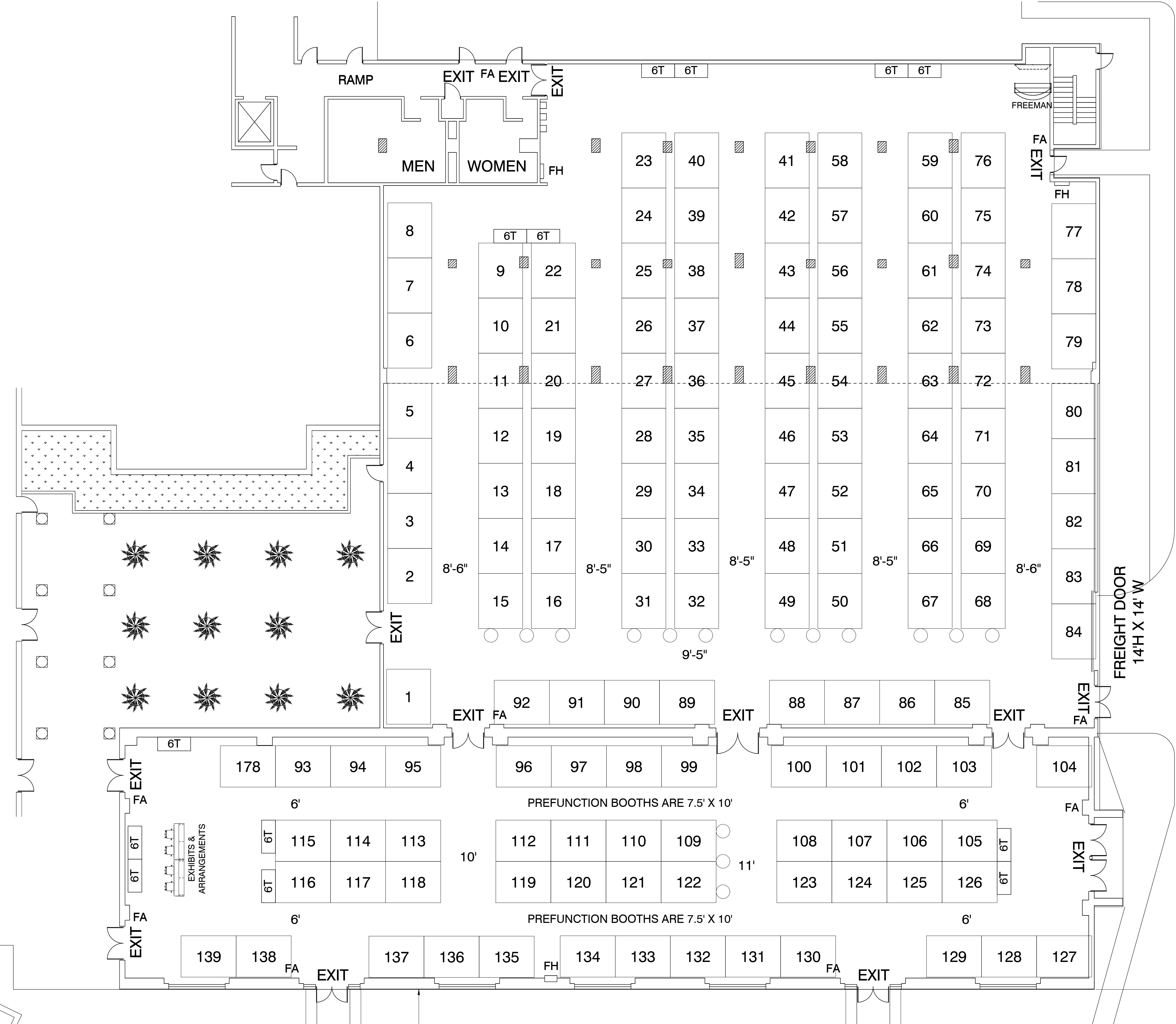

AMERICAN SCHOOL OF GAS MEASUREMENT TECHNOLOGY
SEPTEMBER 16-19, 2019

**HOUSTON MARRIOTT WESTCHASE
EXHIBIT HALL AND PREFUNCTION
HOUSTON, TEXAS**

F R E E M A N

EVERY EFFORT HAS BEEN MADE TO ENSURE THE ACCURACY OF ALL INFORMATION CONTAINED ON THIS FLOORPLAN. HOWEVER, NO WARRANTIES, EITHER EXPRESSED OR IMPLIED, ARE MADE WITH RESPECT TO THIS FLOORPLAN. IF THE LOCATION OF BUILDING COLUMNS, UTILITIES OR OTHER ARCHITECTURAL COMPONENTS OF THE FACILITY IS A CONSIDERATION IN THE CONSTRUCTION OR USAGE OF AN EXHIBIT, IT IS THE SOLE RESPONSIBILITY OF THE EXHIBITOR TO PHYSICALLY INSPECT THE FACILITY TO VERIFY ALL DIMENSION AND LOCATIONS. ©COPYRIGHT 2007, FREEMAN, ALL RIGHTS RESERVED.

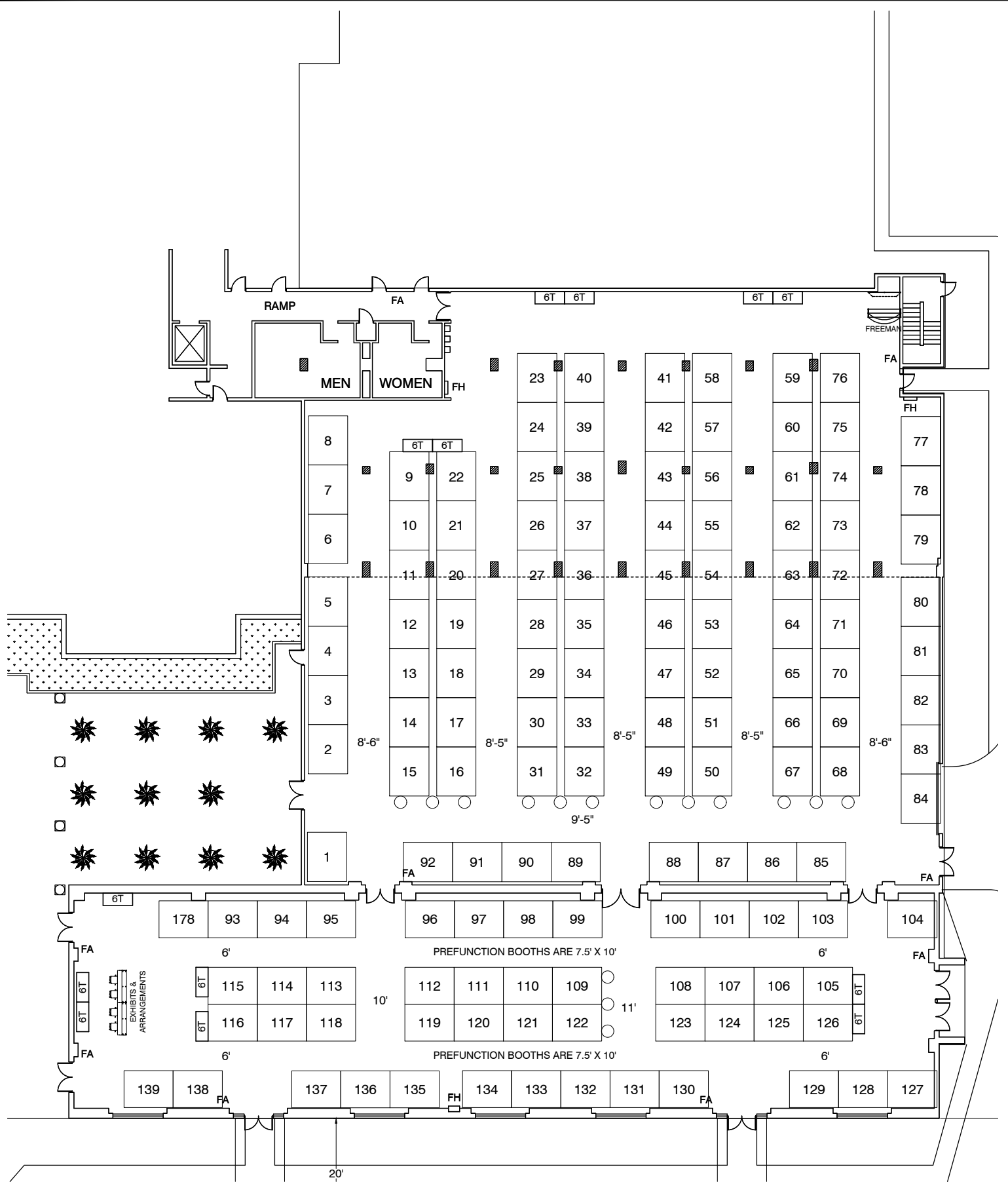

AMERICAN SCHOOL OF GAS MEASUREMENT TECHNOLOGY SEPTEMBER 16-19, 2019

HOUSTON MARRIOTT WESTCHASE - EXHIBIT HALL AND PREFUNCTION - HOUSTON, TEXAS

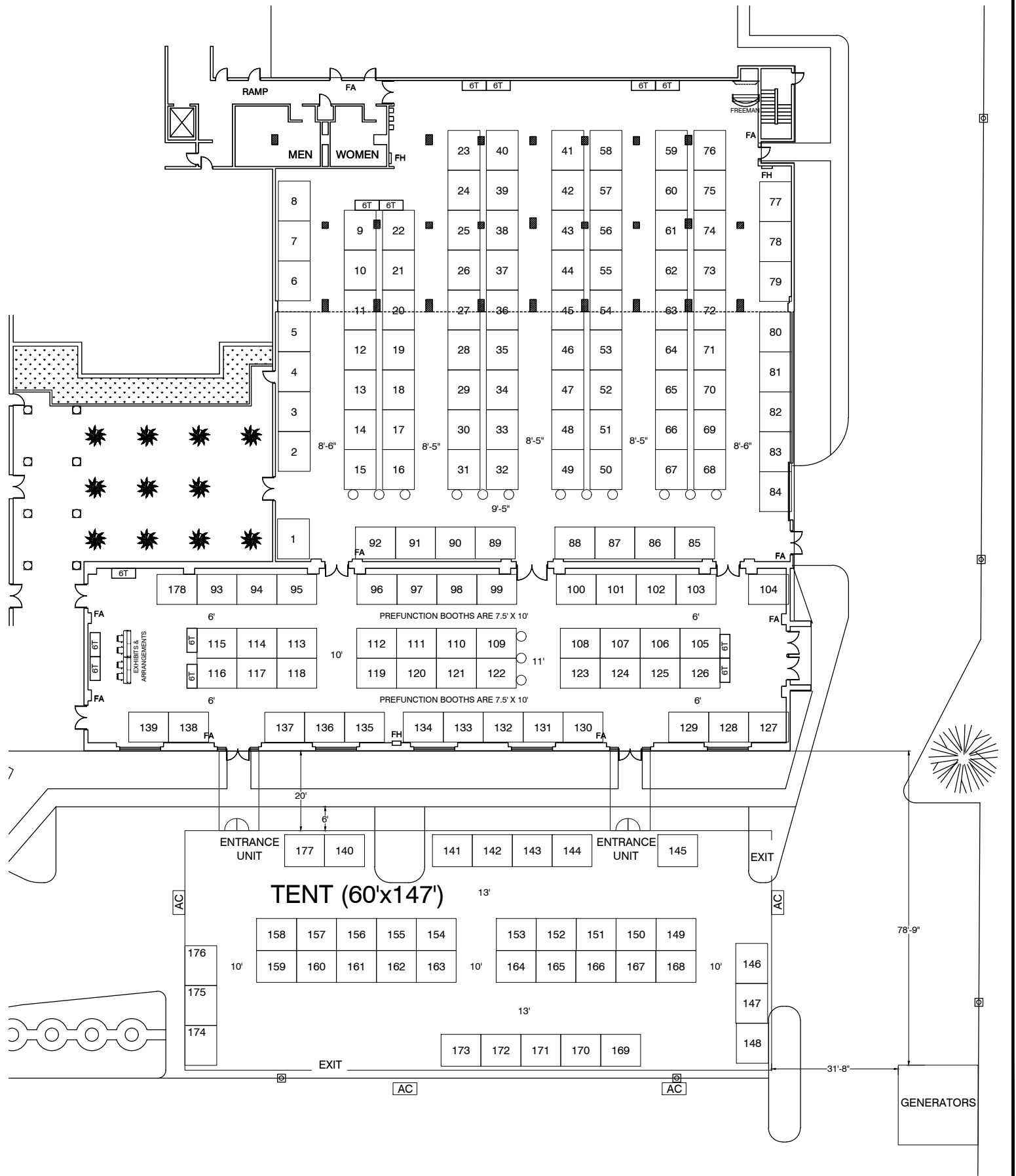

AMERICAN SCHOOL OF GAS MEASUREMENT TECHNOLOGY

SEPTEMBER 16-19, 2019

HOUSTON MARRIOTT WESTCHASE - EXHIBIT HALL AND PREFUNCTION - HOUSTON, TEXAS

**AMERICAN SCHOOL OF
GAS MEASUREMENT
TECHNOLOGY**
SEPTEMBER 16-19, 2019
HOUSTON MARRIOTT WESTCHASE
EXHIBIT HALL AND PREFUNCTION
HOUSTON, TEXAS

Tent as of 05/16/2019

Dimension	Size	Qty	SqFt
8'x10'	80	38	3,040
Totals:		38	3,040

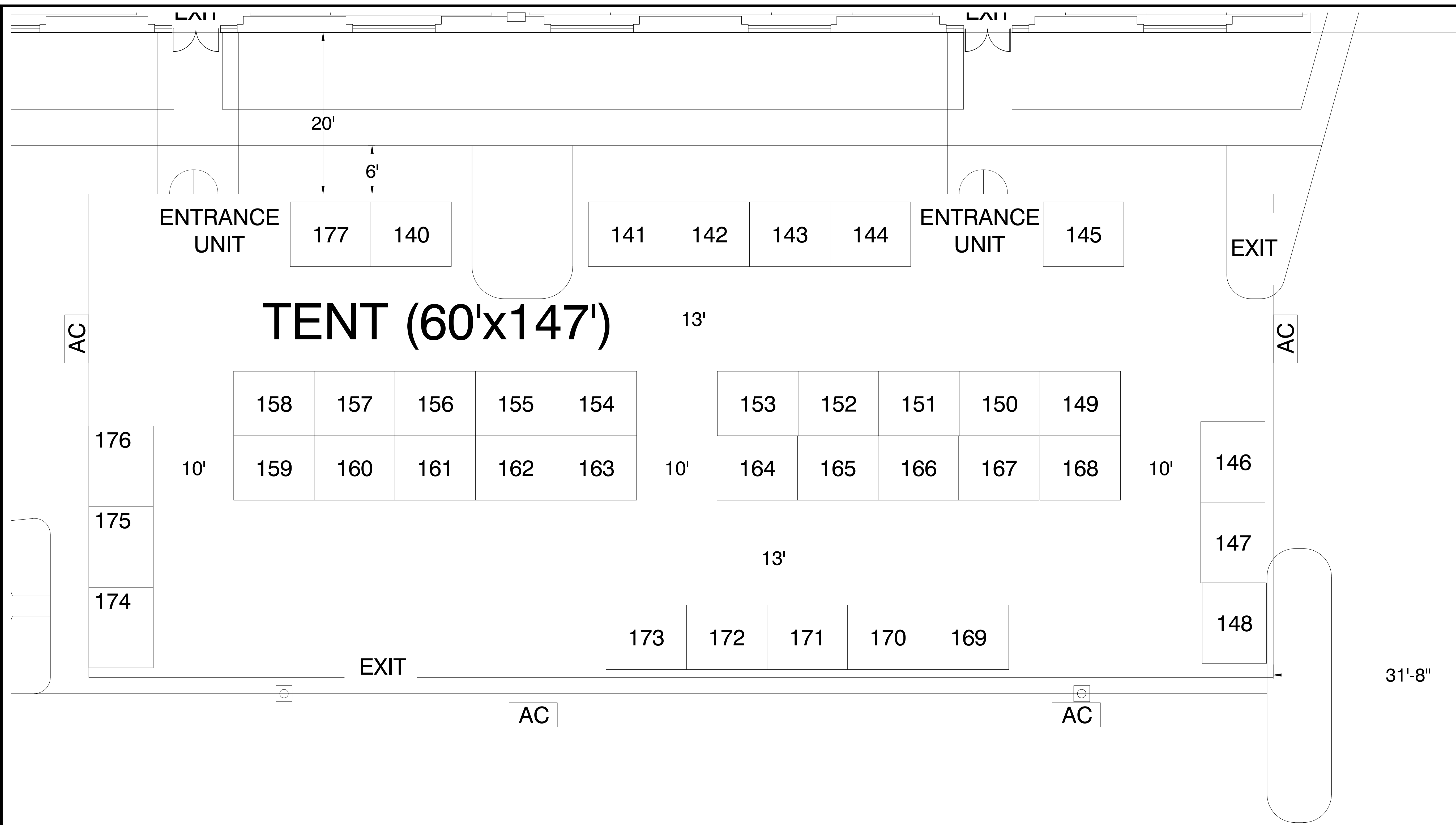

Revision Date: 6/13/2019 Lydia Gonzales

Drawing Started: 05/16/2019

File: P:\Houston\Branch\Design\FLOOR
PLANS\2019\09-Sep\AM SCHOOL OF GAS
MEASUREMENT TECH (454960)\DWG
Files\ASOGM19 EXHIBIT FP.dwg

Job #: 454960

AE: MELISSA VANDERHORST

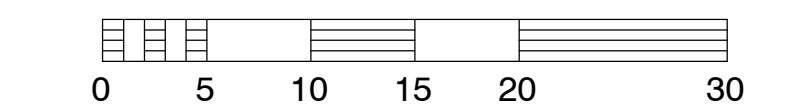

AMERICAN SCHOOL OF GAS MEASUREMENT TECHNOLOGY
SEPTEMBER 16-19, 2019

HOUSTON MARRIOTT WESTCHASE
EXHIBIT HALL AND PREFUNCTION
HOUSTON, TEXAS

F R E E M A N

EVERY EFFORT HAS BEEN MADE TO ENSURE THE ACCURACY OF ALL INFORMATION CONTAINED ON THIS FLOORPLAN. HOWEVER, NO WARRANTIES, EITHER EXPRESSED OR IMPLIED, ARE MADE WITH RESPECT TO THIS FLOORPLAN. IF THE LOCATION OF BUILDING COLUMNS, UTILITIES OR OTHER ARCHITECTURAL COMPONENTS OF THE FACILITY IS A CONSIDERATION IN THE CONSTRUCTION OR USAGE OF AN EXHIBIT, IT IS THE SOLE RESPONSIBILITY OF THE EXHIBITOR TO PHYSICALLY INSPECT THE FACILITY TO VERIFY ALL DIMENSION AND LOCATIONS. ©COPYRIGHT 2007, FREEMAN, ALL RIGHTS RESERVED.